

PRESENT IN MORE THAN 60 COUNTRIES

www.sbm-international.net



CERAMIC HEATING



INFRARED INDUSTRIAL EMITTERS

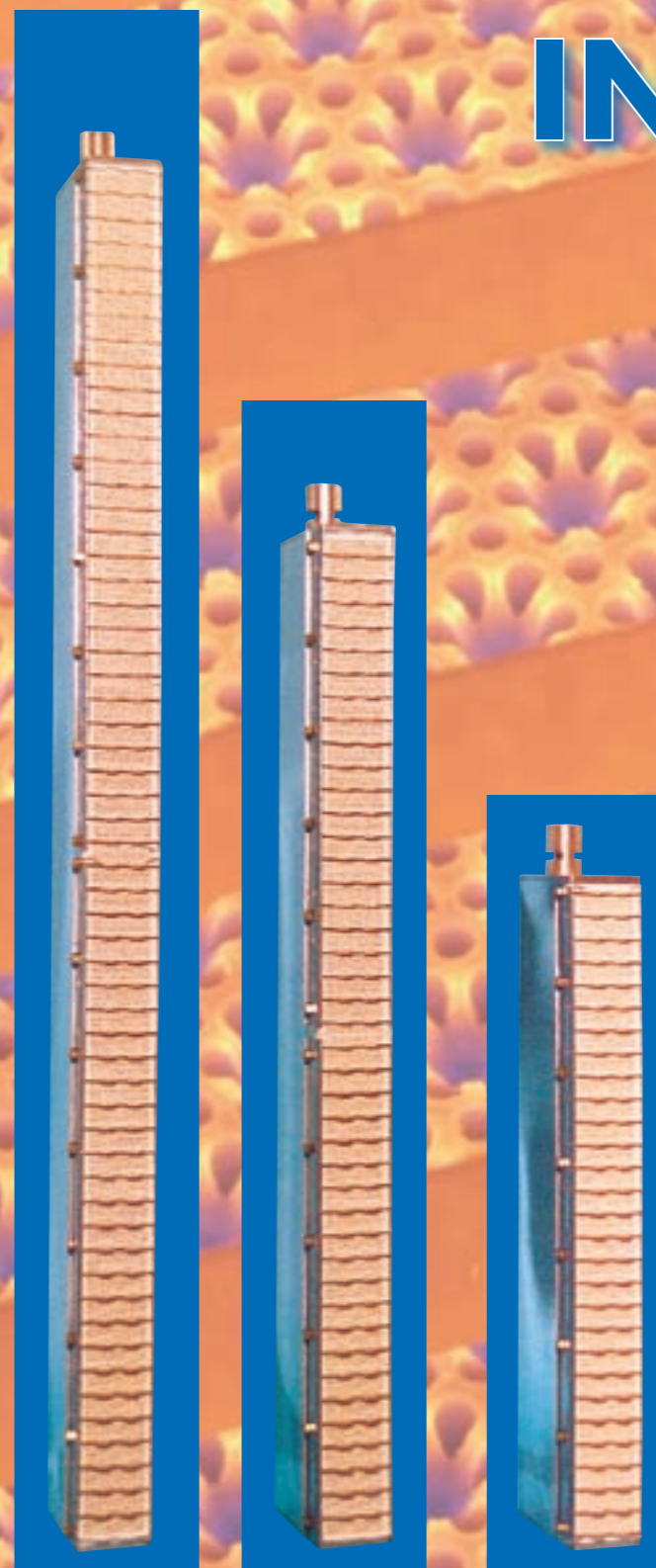

ROTISSERIES

•

BROILERS

•

DONER KEBAB

•

OVENS

SBM International

3 cottages de la Norges - 21490 CLENAY - FRANCE

Tel : (+33) 3 80 76 74 80 • Fax: (+33) 3 80 76 74 89

E-mail : sbm.com@sbm.fr

Visit SBM : our technique, product, manufacturing, quality control and international organization.

INFRARED INDUSTRIAL EMITTERS

- ◆ STAINLESS STEEL CONSTRUCTION WITH CERAMIC EMITTERS
- ◆ HIGHEST RADIANT EFFICIENCY
- ◆ QUIET OPERATION
- ◆ CLEAN GAS COMBUSTION
- ◆ INSTANT HEAT

BR 8ZL
BR 12ZL
BR 16ZL

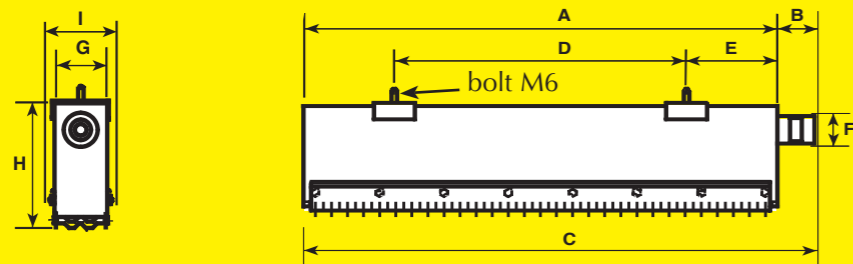

| TYPE | DIMENSIONS (mm) | | | | | | | | | NET WEIGHT (kg) |
|---------|-----------------|----|------|-----|-----|----|----|-----|----|-----------------|
| | A | B | C | D | E | F | G | H | I | |
| BR 8ZL | 522 | 34 | 556 | 322 | 100 | 30 | 58 | 137 | 70 | 1,50 |
| BR 12ZL | 775 | 34 | 809 | 575 | 100 | 38 | 58 | 137 | 70 | 2,20 |
| BR 16ZL | 1028 | 34 | 1062 | 828 | 100 | 38 | 58 | 137 | 70 | 2,70 |

BR 5PNZ
BR 8PNZ

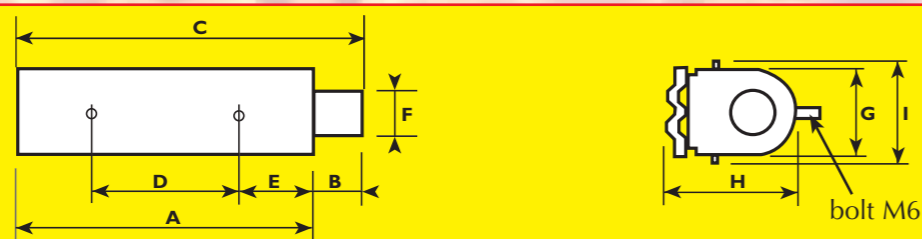

| TYPE | DIMENSIONS (mm) | | | | | | | | | NET WEIGHT (kg) |
|---------|-----------------|----|-----|-----|-----|----|----|----|----|-----------------|
| | A | B | C | D | E | F | G | H | I | |
| BR 5PNZ | 330 | 34 | 364 | 238 | 46 | 30 | 58 | 85 | 70 | 0,80 |
| BR 8PNZ | 519 | 34 | 553 | 309 | 105 | 30 | 58 | 85 | 70 | 1,30 |

BR 6Z F16

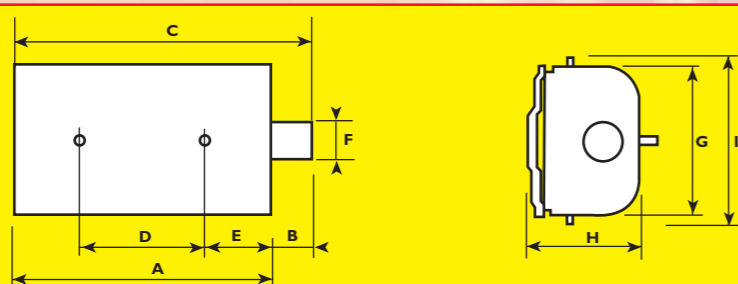

| TYPE | DIMENSIONS (mm) | | | | | | | | | NET WEIGHT (kg) |
|-----------|-----------------|----|-----|-----|------|----|-----|----|-----|-----------------|
| | A | B | C | D | E | F | G | H | I | |
| BR 6Z F16 | 205 | 34 | 239 | 100 | 52,5 | 30 | 117 | 85 | 129 | 0,90 |

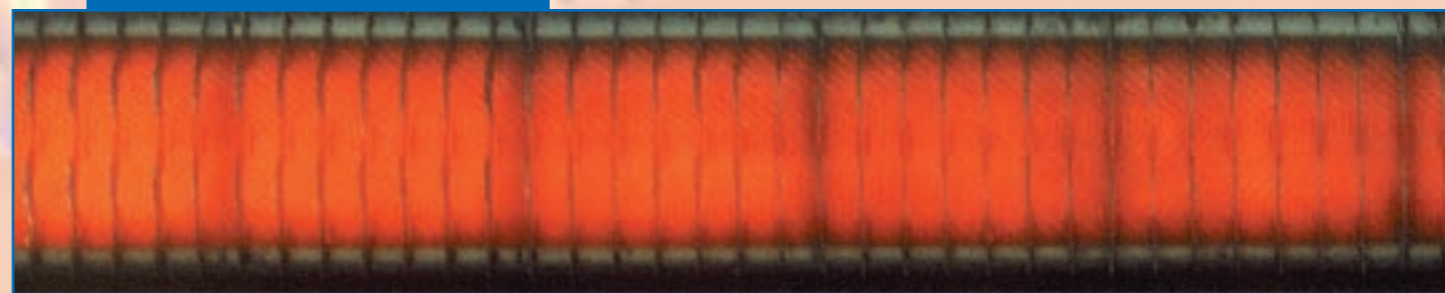

IGNITION

- Manual
- or ■ Automatic

GAS / INLET PRESSURE

- G31 (Propane) 37 mbar.
- or ■ G20 (Natural Gas type H) 20 mbar.
- or ■ Other : Include a detailed chemical composition and calorific value.

GAS FITTING

- 1/2" male (G 1/2) cylindrical.

INJECTOR BLOCK

- Axial
- or ■ 90° elbow

| TYPE | POWER (in Watt) | MAXIMUM GAS CONSUMPTION | |
|-----------|-----------------|-------------------------|------------------------|
| | | G31 Propane | G20 Nat. Gas type H |
| BR 8ZL | 3 500 | 250 g/h | 0,34 m ³ /h |
| BR 12ZL | 5 250 | 375 g/h | 0,50 m ³ /h |
| BR 16ZL | 7 000 | 500 g/h | 0,67 m ³ /h |
| BR 5 PNZ | 2 220 | 156 g/h | 0,21 m ³ /h |
| BR 8 PNZ | 3 500 | 250 g/h | 0,34 m ³ /h |
| BR 6Z F16 | 3 000 | 215 g/h | 0,28 m ³ /h |

Please contact us for any additional request or information.